



Università degli Studi *Mediterranea* di Reggio Calabria

**Corso di Laurea in Scienze dell'Architettura**

**Corso di Laurea Triennale L-17**

Anno Accademico 2014-2015

**Corso di FONDAMENTI DI URBANISTICA**

Docente: Prof. Domenico PASSARELLI

Collaborazione: Arch. Sante FORESTA

**MATERIALI PER L'ESERCITAZIONE PRATICA**

**COME DISEGNARE UNO STRUMENTO URBANISTICO ATTUATIVO**





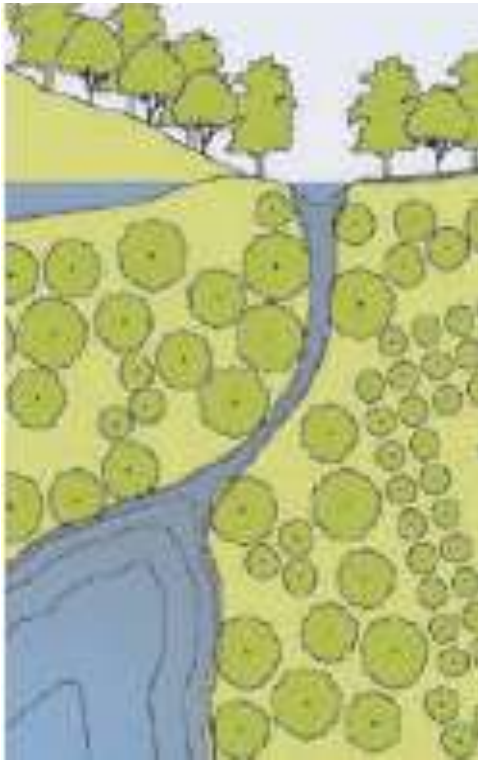

**VERDE PUBBLICO ATTREZZATO**

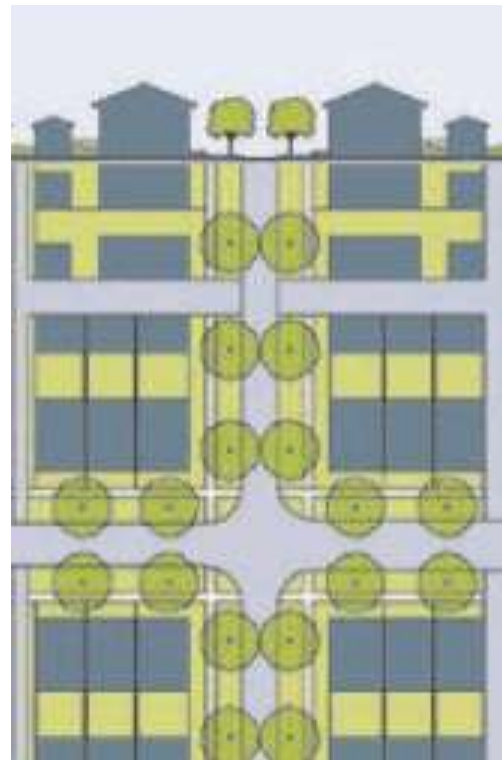
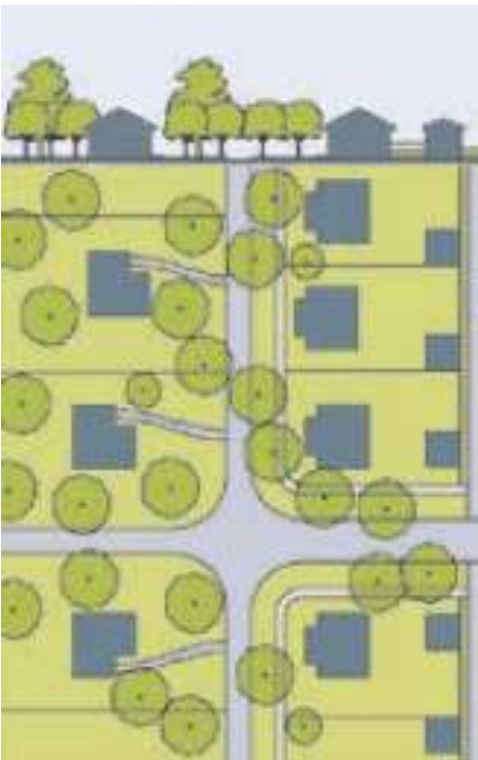

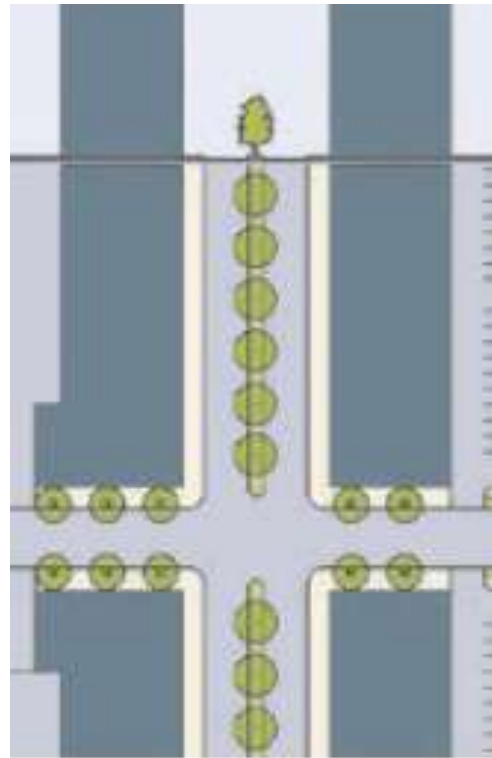
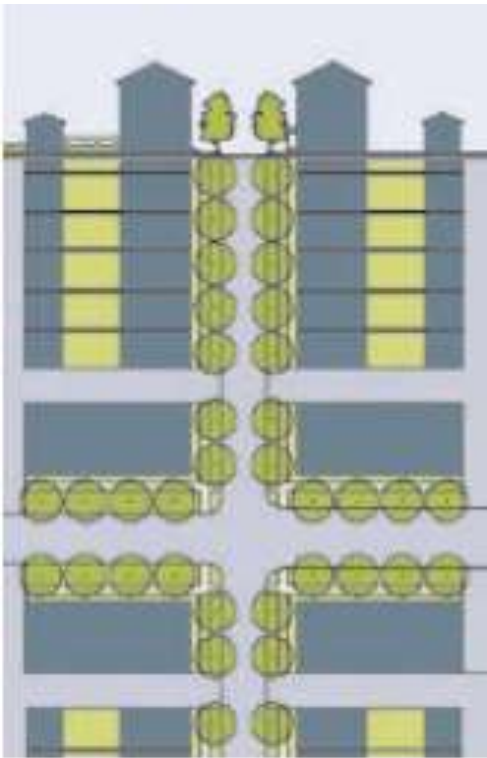

**VERDE PUBBLICO**

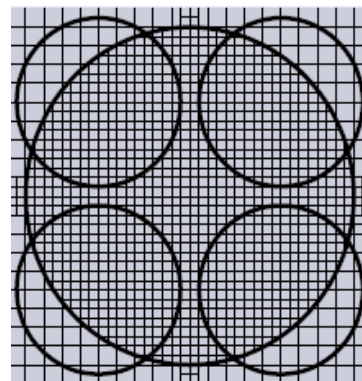
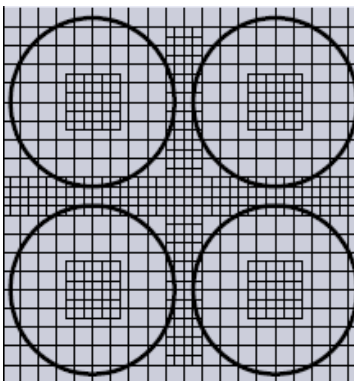
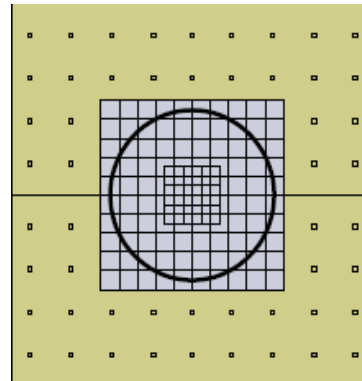
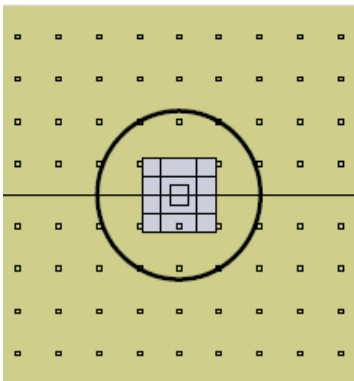

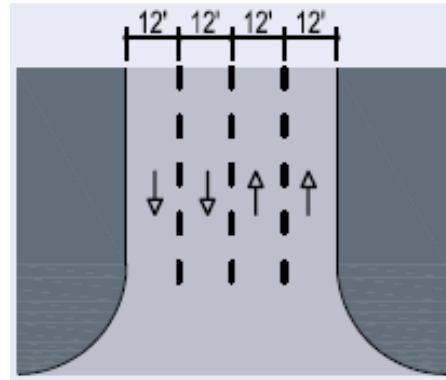
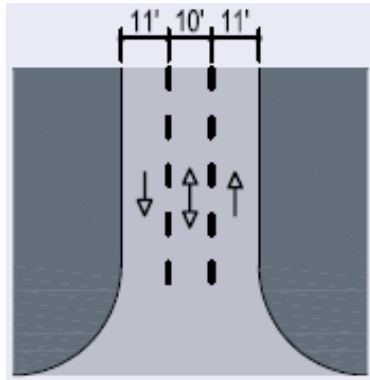
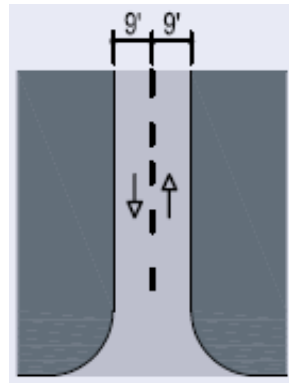
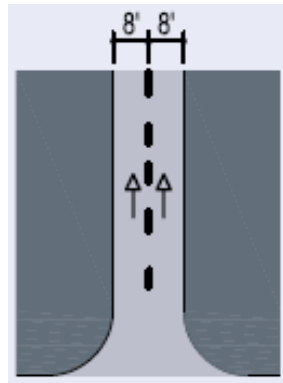
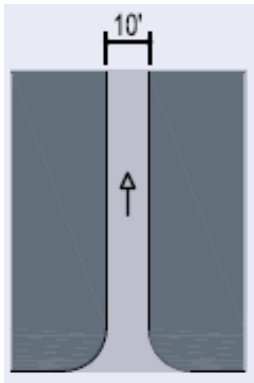

**PARCHEGGI**

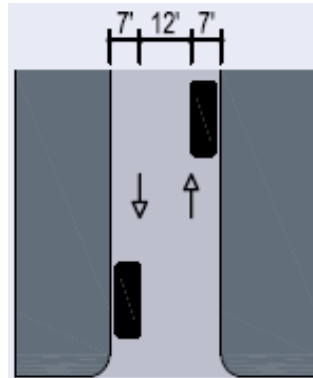
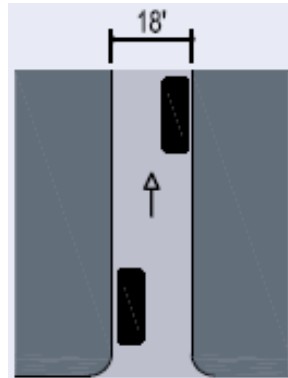

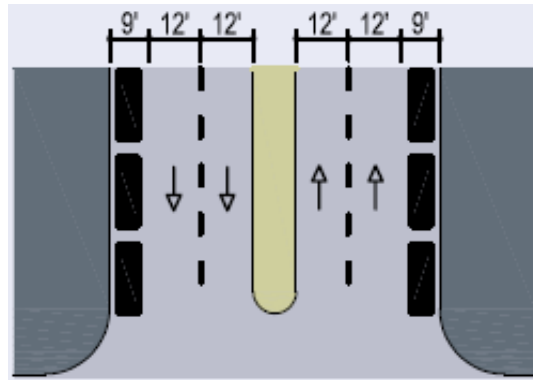
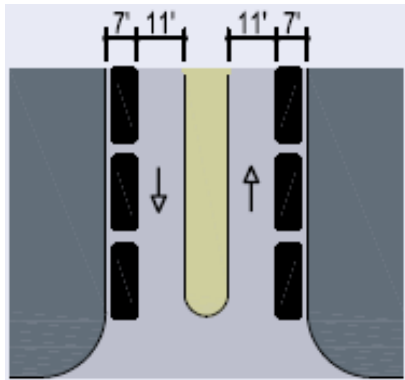
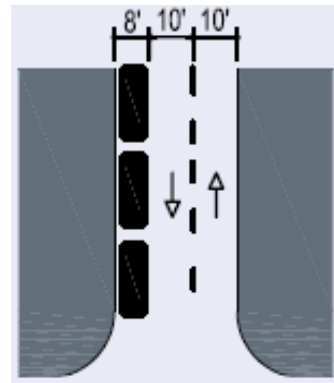
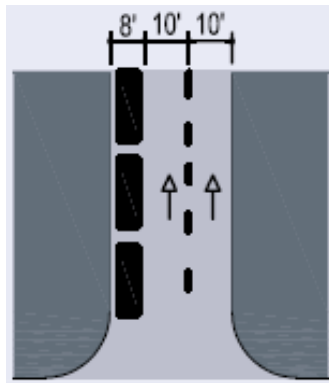
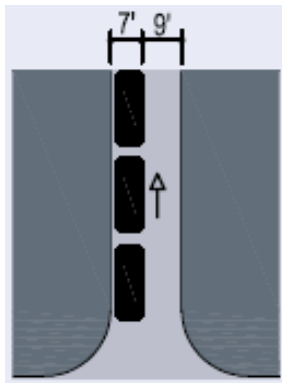

**PARCHEGGI**

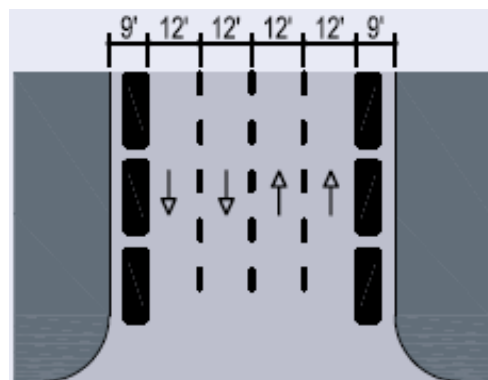
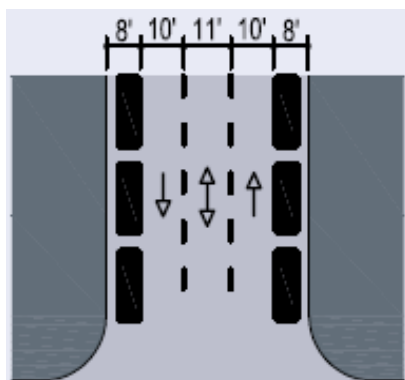
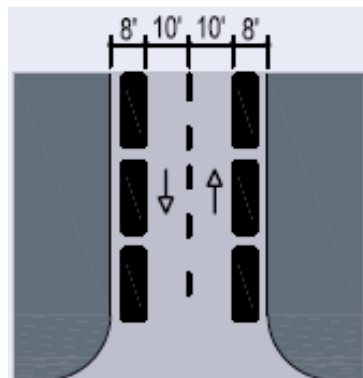
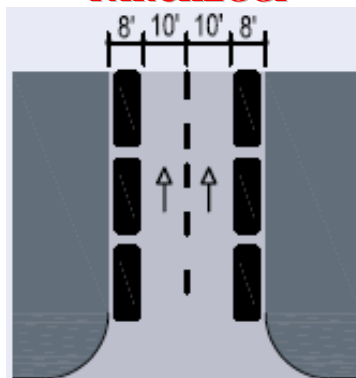
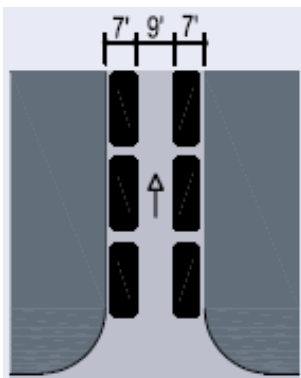

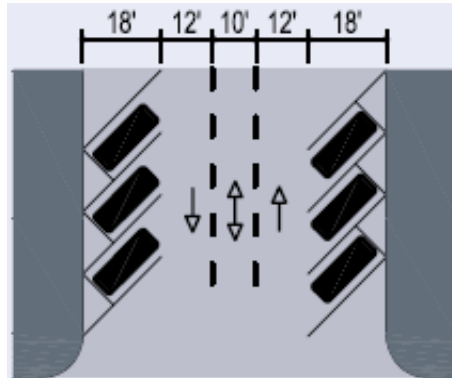
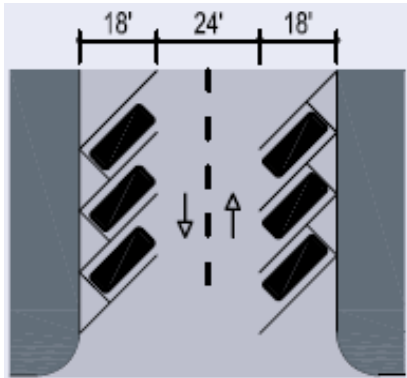
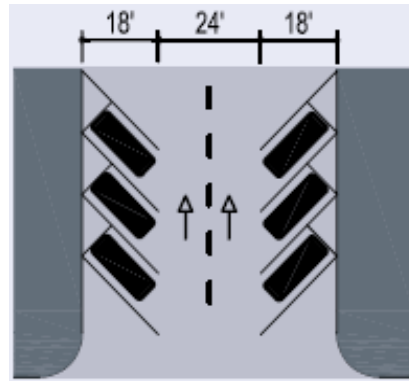
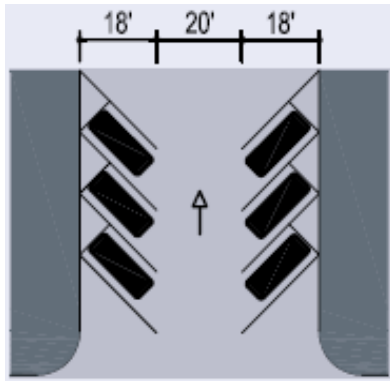

**PARCHEGGI**

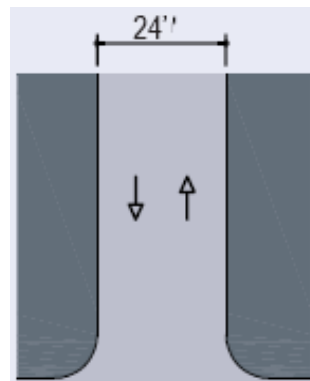
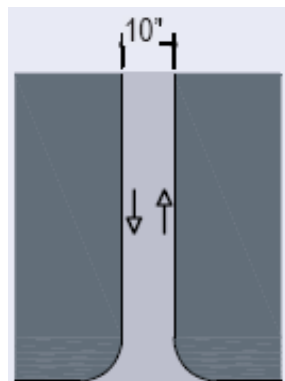
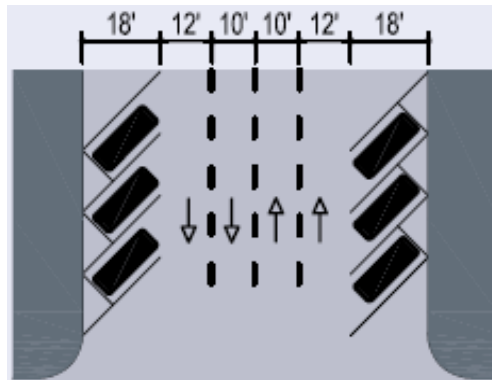

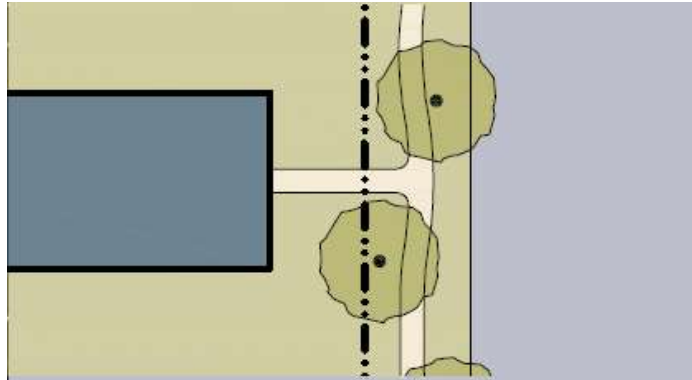
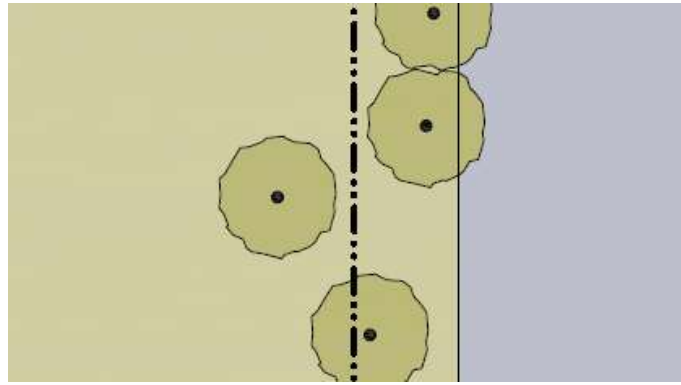

**DISPOSIZIONE DEI MANUFATTI EDILIZI**

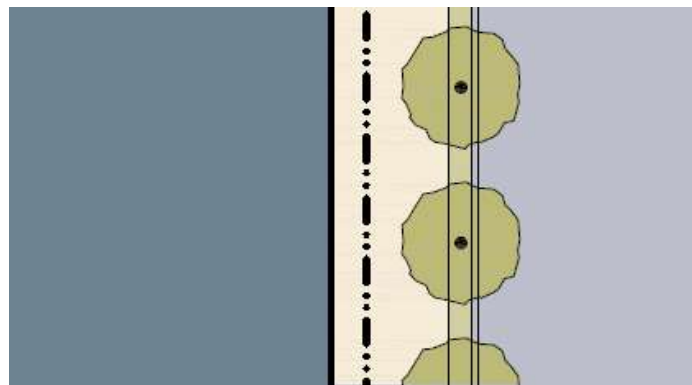
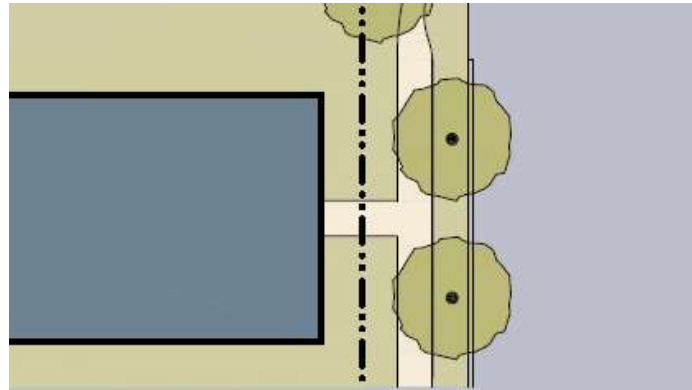



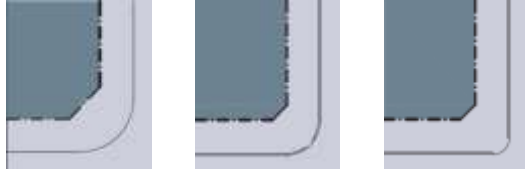
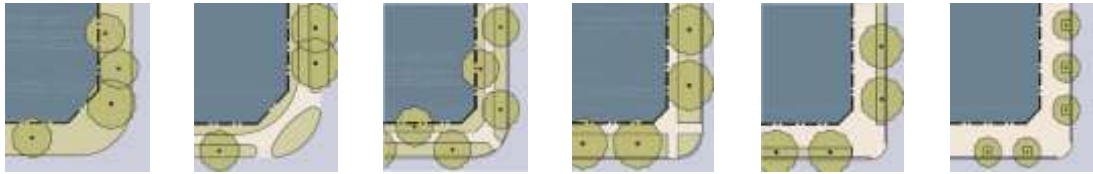

**DISPOSIZIONE DEI MANUFATTI EDILIZI**

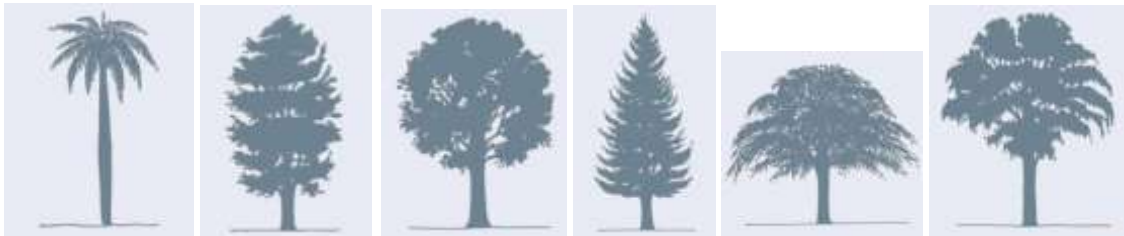
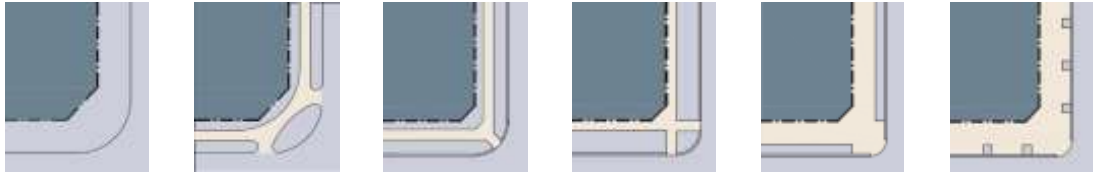

**IL VERDE PRIVATO**

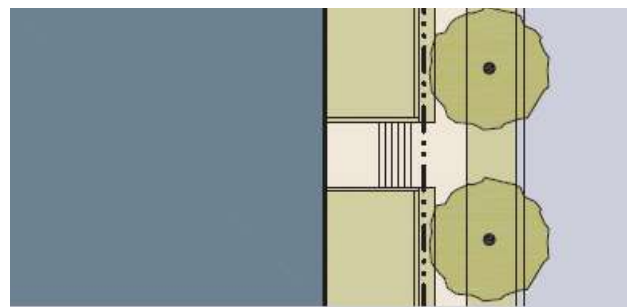
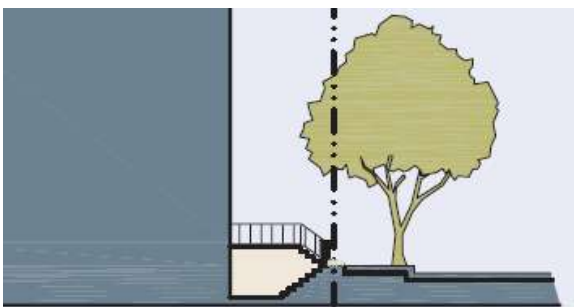
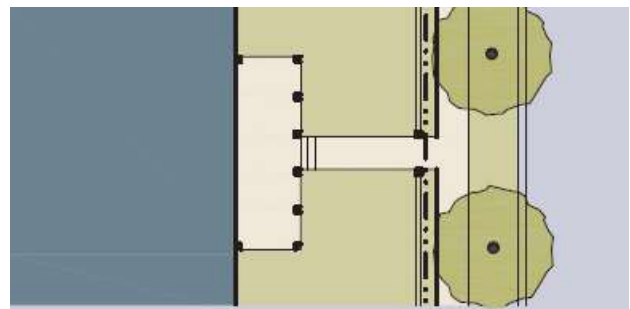
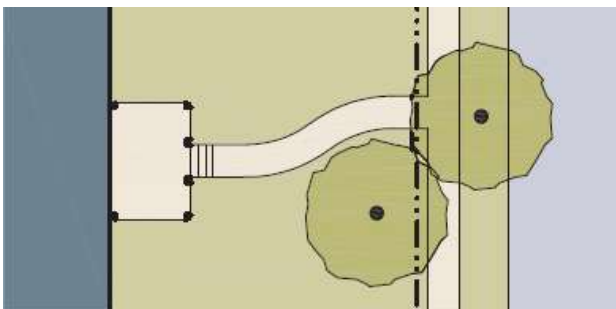
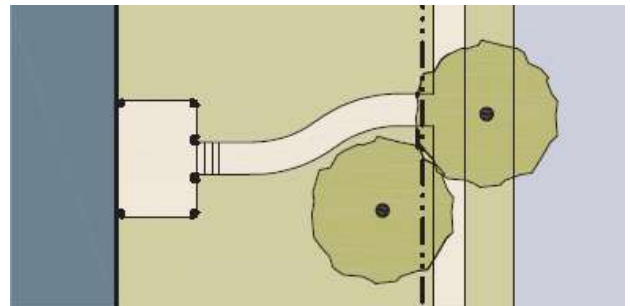
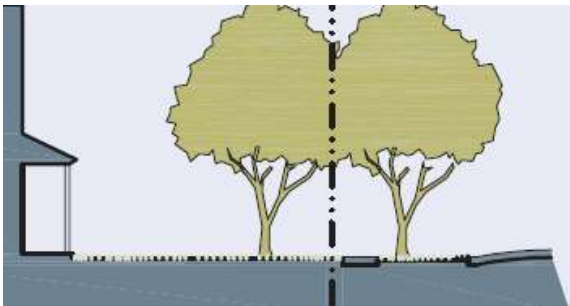



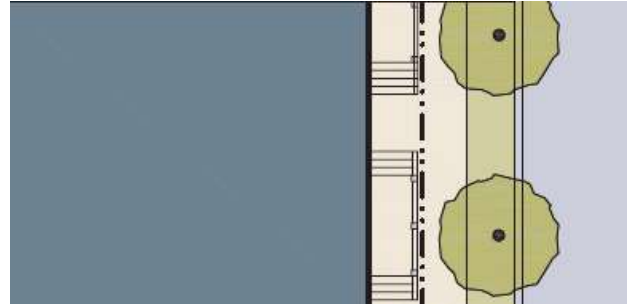
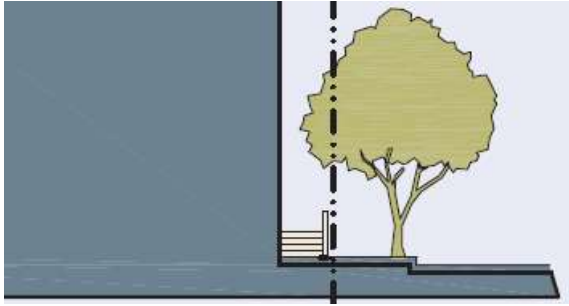
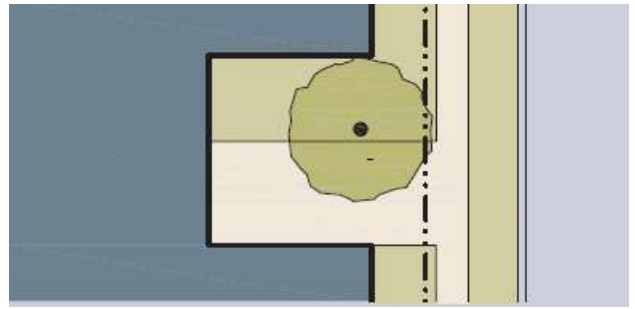
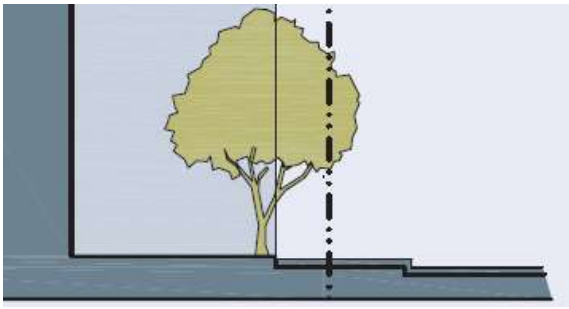

**IL VERDE PRIVATO**

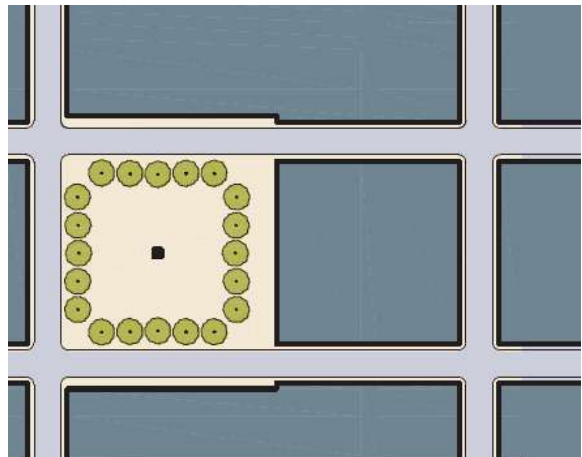
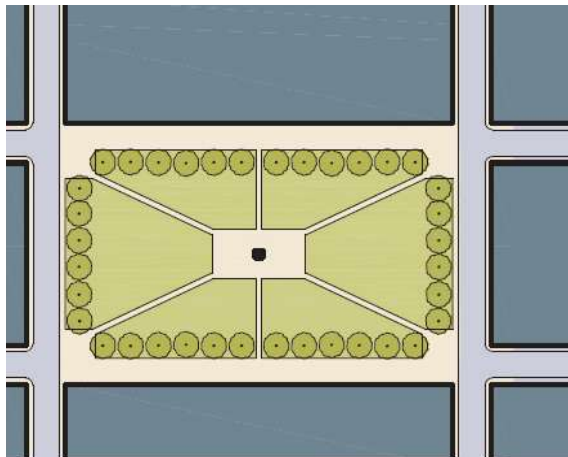
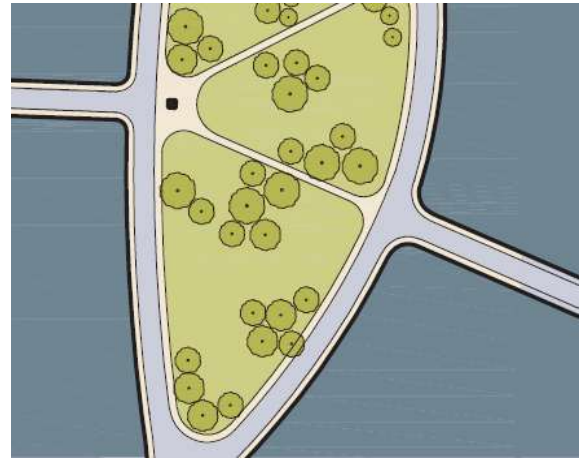
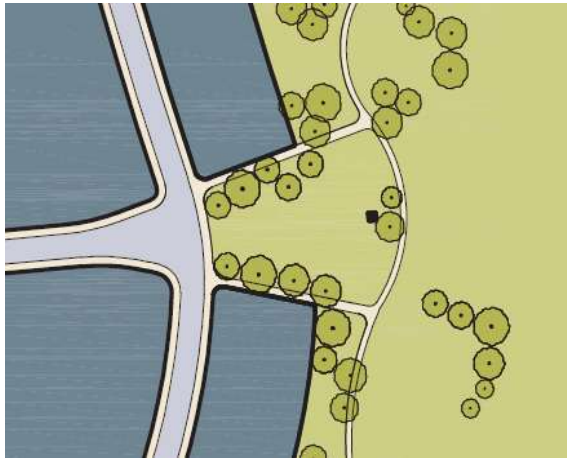

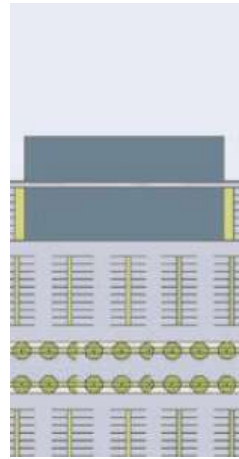
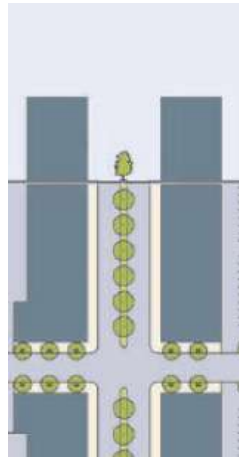
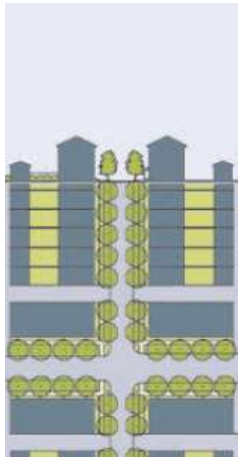
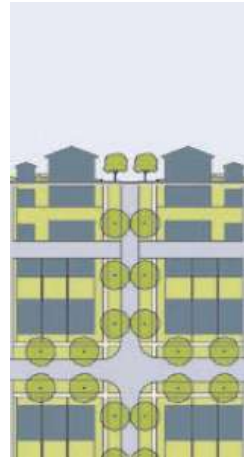
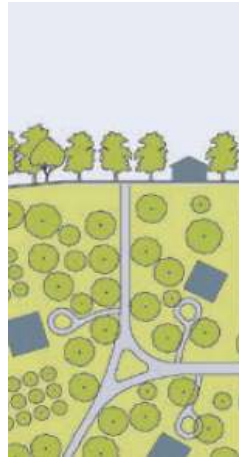
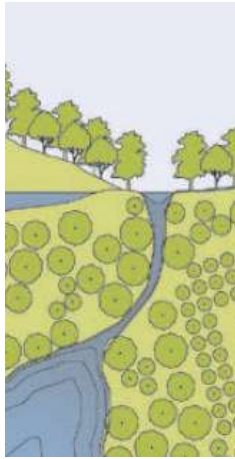
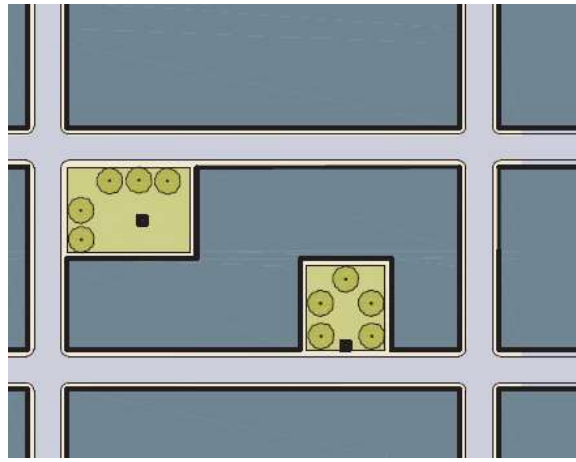

**ILOTTI**

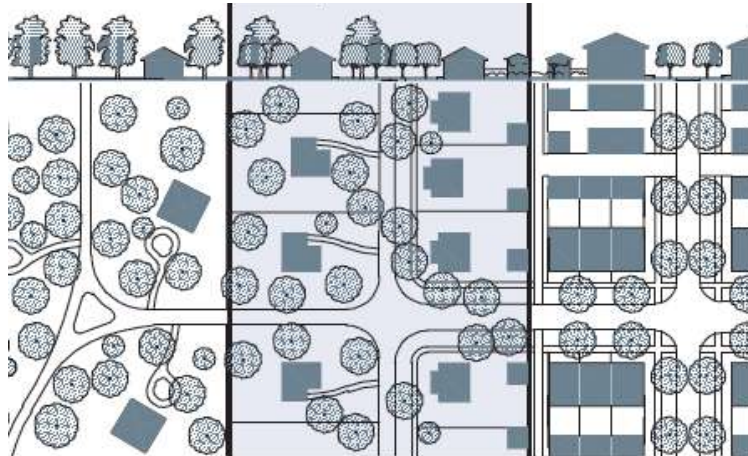

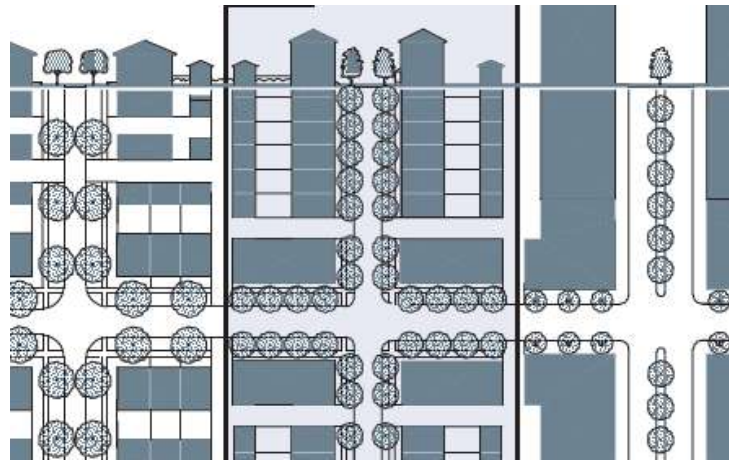
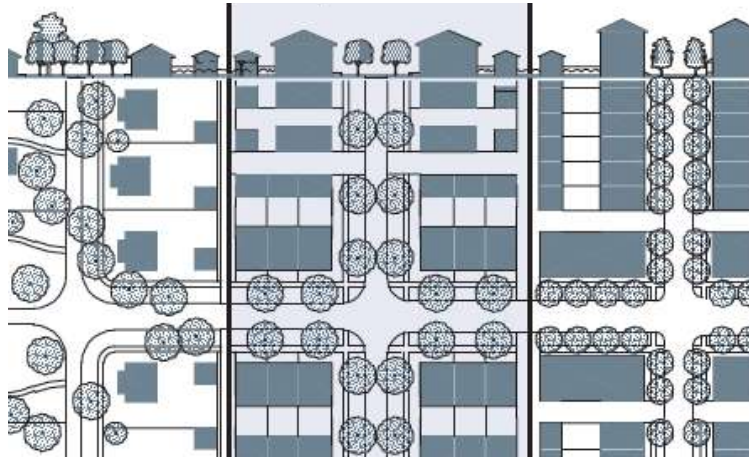

**I LOTTI**

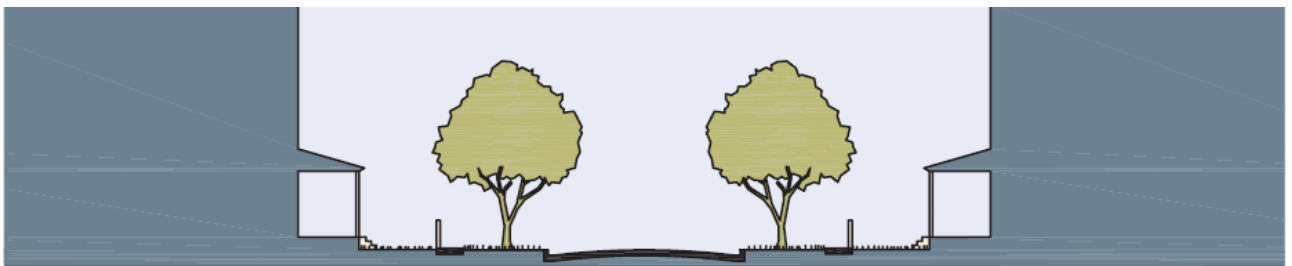
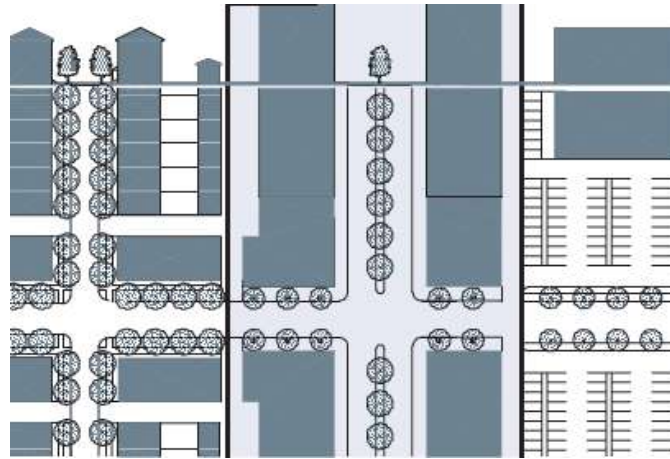





# NEW URBANISM





# NEW URBANISM

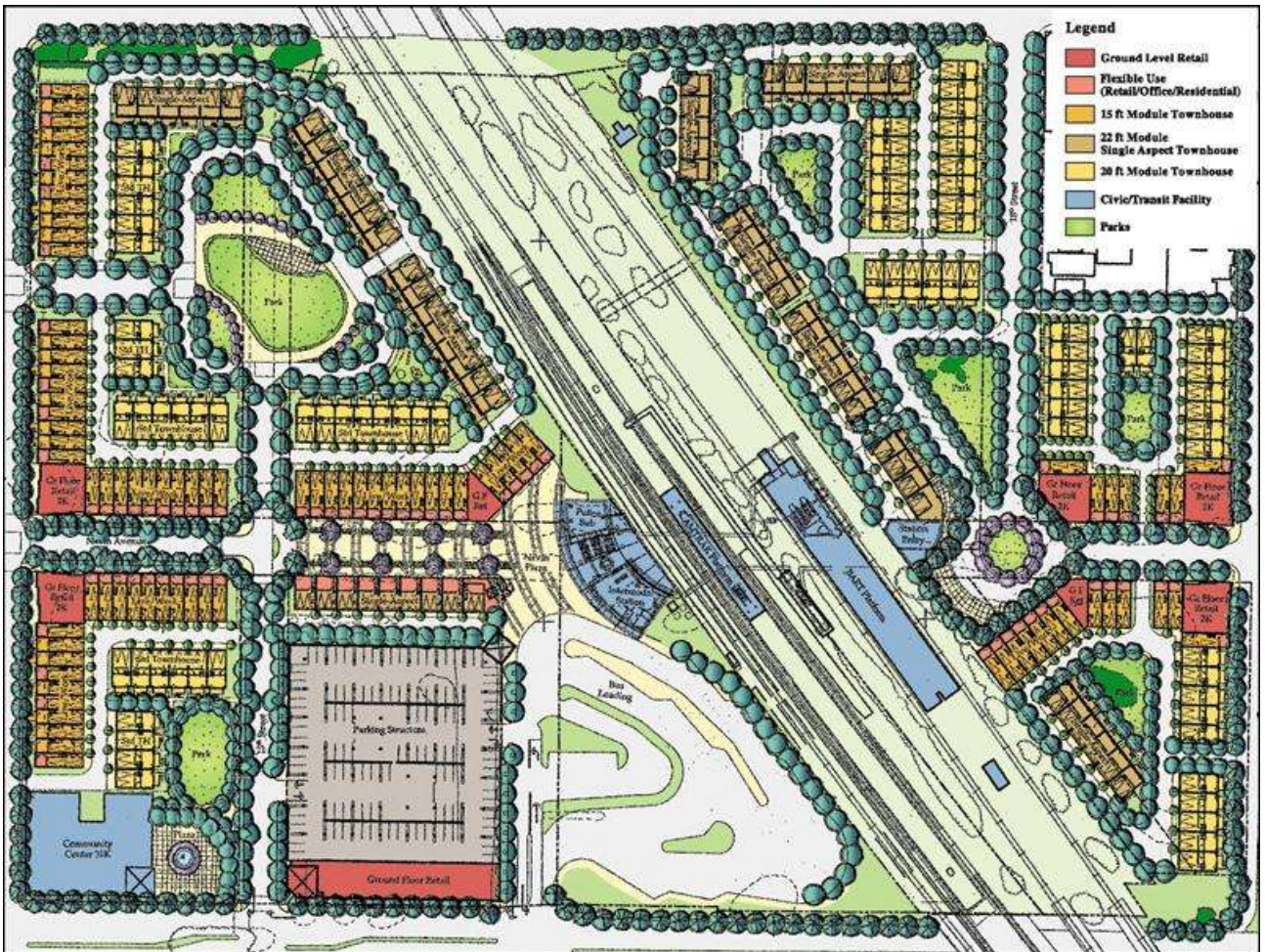







Image credit: V. Yeliseyev, B. Torti Gallas and Partners



# NEW URBANISM





# NEW URBANISM









